



CANADA



WILSON TOOL INTERNATIONAL
UNITIZED TOOLING

2026

ABOUT WILSON TOOL INTERNATIONAL

From humble beginnings in a small manufacturing facility in St. Paul, Minnesota, Wilson Tool International has added manufacturing facilities and sales channels around the world to better serve our thousands of global customers. Throughout our expansion, our mission has never wavered — we continue to offer products and services that help you be more successful. Every product you buy, every employee with whom you communicate, and every training event you attend, are designed to help customers just like you be more successful.

At Wilson Tool, we continue to invest in your success through constant innovation. Our tooling and solutions represent decades of knowledge and experience in assisting manufacturers resolve their most challenging fabrication issues. We understand that no two jobs are the same. Change is the only constant manufacturing. So, working with a tooling supplier who's flexible, nimble, and knowledgeable is important.

Our goal is to deliver exceptional
customer service
along with the most reliable and
innovative products and solutions
so that our **customers**
can be more successful."

When you have a challenge, reach out to us. At Wilson Tool we are more than tools... we are solutions. Your local Sales Engineer is available in person, by phone and through e-mail. Let us put our many decades of expertise to the test. We will work with you to find the best possible solution to whatever challenge you may be facing. And every order comes with our guarantee to outperform your current tooling.

From all of us at Wilson Tool, thank you for the trust you have placed in us to provide products and services that are critical to your business. We look forward to your continued success as we head into the future.



TABLE OF CONTENTS

About Unitized Tooling.. 4-5

A Series..6-18

A-1"	6
AJ-1"	7
A-1¼"	8
AJ-1¼"	9
A-1½"	10
AJ-1½"	11
A-2"	12
AJ-2"	13
A-2½"	14
AJ-2½"	15
A-3½"	18
A-5½"	18

F Series16-17

FCU-1¼"	16
FCU-1½"	17

B Series.. 19-22

BX-¾"	19
B-1"	20
B-1¼"	20
B-1¾"	21
BX-2¼"	21
B-3"	22
B-5"	22

G Series.. 23

G-¾" Triple Spring..	23
G-¾" Single Spring.	23

Ironworker Tooling 24

Whitney-Style Tooling 25

The Divisions of Wilson Tool.. 26

Custom Units 27

ALSO AVAILABLE FROM WILSON TOOL

- Bed Rail and Ram Plate
- Replacement Parts
- Wilson Tool C-Frame (for B-Station Thick Turret Tooling)
- Multicyl Units for use with C-Frame Units
- Miscellaneous Tooling
 - Shearing Tool
 - Custom Piercing Units for Extruded Parts



Custom Piercing Unit

Multicyl Units

TABLE OF CONTENTS

CONNECT WITH WILSON TOOL



Visit wilsontool.com or social media for the latest info, news, videos and product releases.



TERMS AND CONDITIONS

Please note, all orders are subject to Wilson Tool International's Terms and Conditions which include pricing, payment, delivery, warranties, and our return policy. To view our full Terms and Conditions, visit wilsontool.com/en-us/terms-conditions.

Information in this catalog, including pricing and product availability, is subject to change. Wilson Tool International reserves the right to modify data, specifications, and illustrations without notice and are not liable for errors or printing mistakes.



A SERIES TOOLING

A and AJ Units are the most versatile for punching sheet metal — whether flat, angled, channels, extrusions or formed. They are used for up to 1/4" thick material depending on type. Different widths are available, allowing you to gang units as needed for your design. All units can come with adapters or pedestal dies that are interchangeable with all type of units. (A units are sufficient if you are only punching flat material, but your options for future projects are reduced.)

B SERIES TOOLING

B and BX Units are ideal for lighter duty punching applications and for press environments with limited opening. They are widely used in industry to punch mild steel in thickness up to 10 gauge.

F SERIES TOOLING

F Units are designed with excess feed clearance that allows for front feeding (instead of side loading) the extrusion or parts.

G SERIES TOOLING

The **G Triple Spring Unit** has a 7-1/2" shut height and is designed for round hole punching. Its advantage comes from the additional stripping spring force allowing the unit to be used to punch .3125" round holes in 3/16" material. (For thicker punching applications, see "A" or "B" Series.)

UNITIZED TOOLING

Unitized tooling offers flexibility for various applications, including press brakes, Multicyl setups, and presses. For press brakes, simply attach the units to a bed rail or use a job-specific template. These templates function as a plug-and-play system: attach the template to the machine, secure it and begin punching parts. Once finished, remove the entire plate, including the mounted units. To reduce weight, the plates can be segmented.

Bed rails with adjustable spacers allow you to easily reposition units to accommodate various specifications. Sliding on the face of the bed rails, combined with universal stops on the sides and back, ensure accurate and consistent placement of extruded or flat sheets. This flexibility enables repeatable production processes.

Plate Mounted

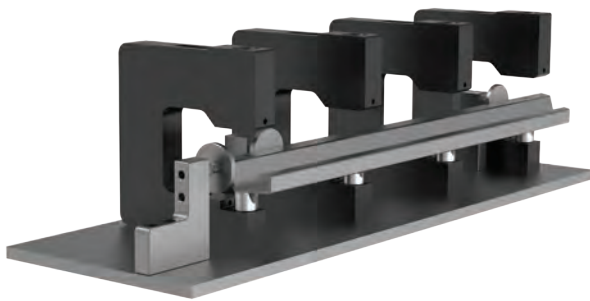

Bed Rail Mounted



Multicyl Units



A-1"

WIDTH: 1" [25.4mm]

SPECIFICATIONS & OPERATING INSTRUCTIONS

MAX. MATERIAL THICKNESS	Mild Steel	1/4" [6.35mm]
	Stainless Steel	3/32" [2.38mm]
MAX. PUNCH DIAMETER / A DIMENSION	1/4" [6.4mm] thick Mild Steel	.3125" [7.93mm]
	1/8" [3.18mm] thick S. Steel	.4375" [11.1mm]
MIN. PUNCH DIAMETER		.0937" [2.38mm]

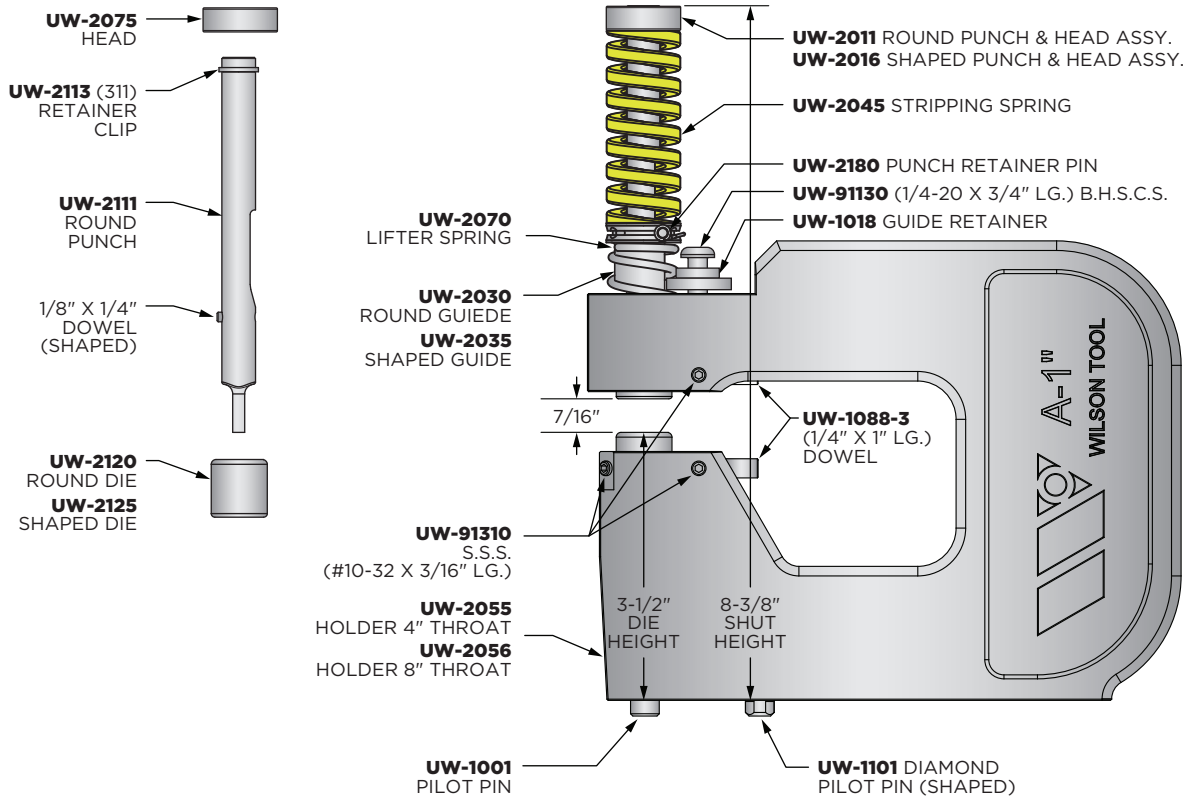

THROAT	ROUND UNITS		SHAPED UNITS	
	MODEL #	PART #	MODEL #	PART #
BASE UNITS LESS PUNCH & DIE				
4"	UW-4A-1-LPD	UW-2003-LPD	UW-4SA-1-LPD	UW-2005-LPD
8"	UW-8A-1-LPD	UW-2000-LPD	UW-8SA-1-LPD	UW-2006-LPD

AJ-1"

WIDTH: 1" [25.4mm]

SPECIFICATIONS & OPERATING INSTRUCTIONS

MAX. MATERIAL THICKNESS	Mild Steel	1/4" [6.4mm]
	Stainless Steel	1/8" [3.18mm]
MAX. PUNCH DIAMETER / A DIMENSION	1/4" [6.4mm] thick Mild Steel	.3125" [7.93mm]
	1/8" [3.18mm] thick S. Steel	.4375" [11.1mm]
MIN. PUNCH DIAMETER		.0937" [2.38mm]

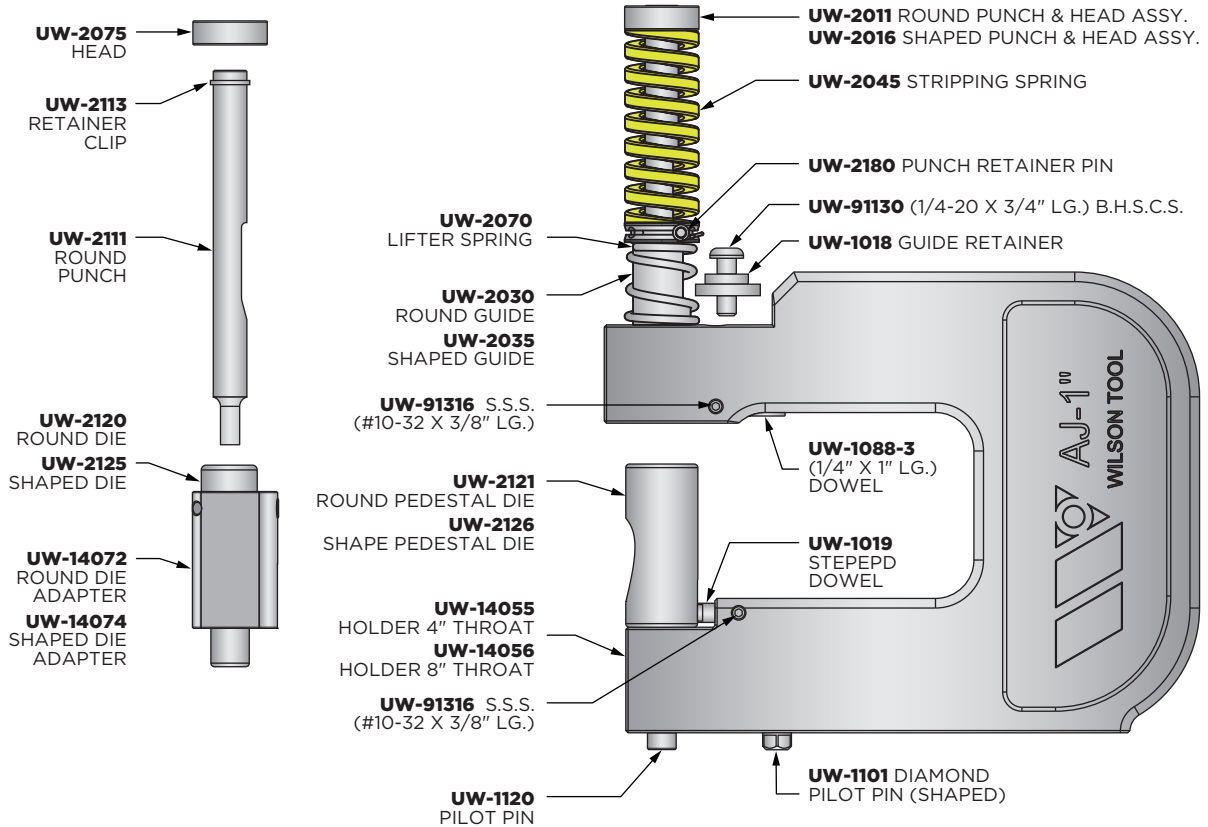

NOTE: All components are interchangeable with A units except the pedestal dies.

THROAT	ROUND UNITS		SHAPED UNITS	
	MODEL #	PART #	MODEL #	PART #
BASE UNITS LESS PUNCH, DIE & DIE ADAPTER				
4"	4A J-1P-LPD	UW-14000P-LPD	4SAJ-1P-LPD	UW-14005P-LPD
8"	8A J-1P-LPD	UW-14001P-LPD	8SAJ-1P -LPD	UW-14006P-LPD
BASE UNITS LESS PUNCH & DIE (includes die adapter)				
4"	4A J-1A-LPD	UW-14000A-LPD	4SAJ-1A-LPD	UW-14005A-LPD
8"	8A J-1A-LPD	UW-14001A-LPD	8SAJ-1A-LPD	UW-14006A-LPD

A SERIES TOOLING

A-1 1/4"

WIDTH: 1-1/4" [31.8mm]

SPECIFICATIONS & OPERATING INSTRUCTIONS

MAX. MATERIAL THICKNESS	Mild Steel	1/4" [6.35mm]
	Stainless Steel	3/32" [2.38mm]
MAX. PUNCH DIAMETER / A DIM.	.4375" [11.11mm]	
MIN. PUNCH DIAMETER	.0937" [2.38mm]	

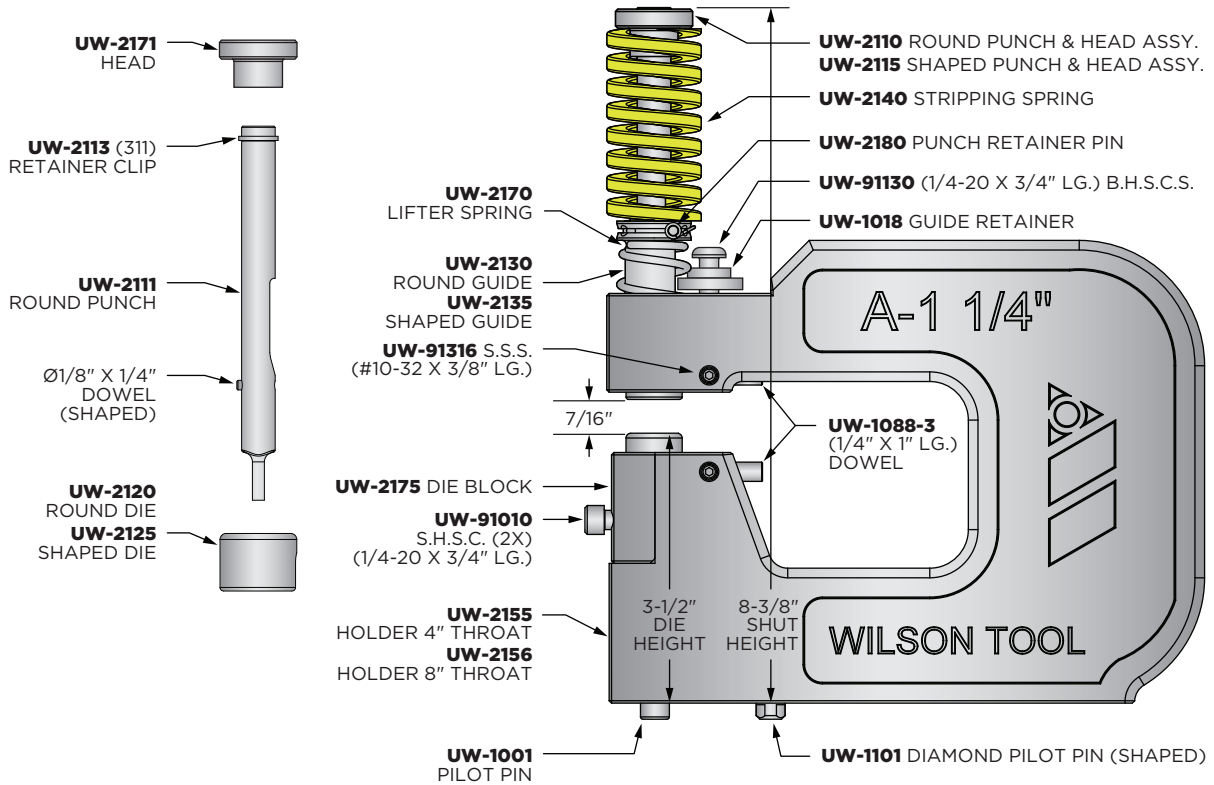

THROAT	ROUND UNITS		SHAPED UNITS	
	MODEL #	PART #	MODEL #	PART #
BASE UNITS LESS PUNCH & DIE				
4"	UW-4A-1/4-LPD	UW-2103-LPD	UW-4SA-1/4-LPD	UW-2105-LPD
8"	UW-8A-1/4-LPD	UW-2100-LPD	UW-8SA-1/4-LPD	UW-2106-LPD

AJ-1 1/4"

WIDTH: 1-1/4" [31.8mm]

SPECIFICATIONS & OPERATING INSTRUCTIONS

MAX. MATERIAL THICKNESS	Mild Steel	1/4" [6.4mm]
	Stainless Steel	1/8" [3.18mm]
MAX. PUNCH DIAMETER / A DIM.	.4375" [11.1mm]	
MIN. PUNCH DIAMETER	.0937" [2.38mm]	

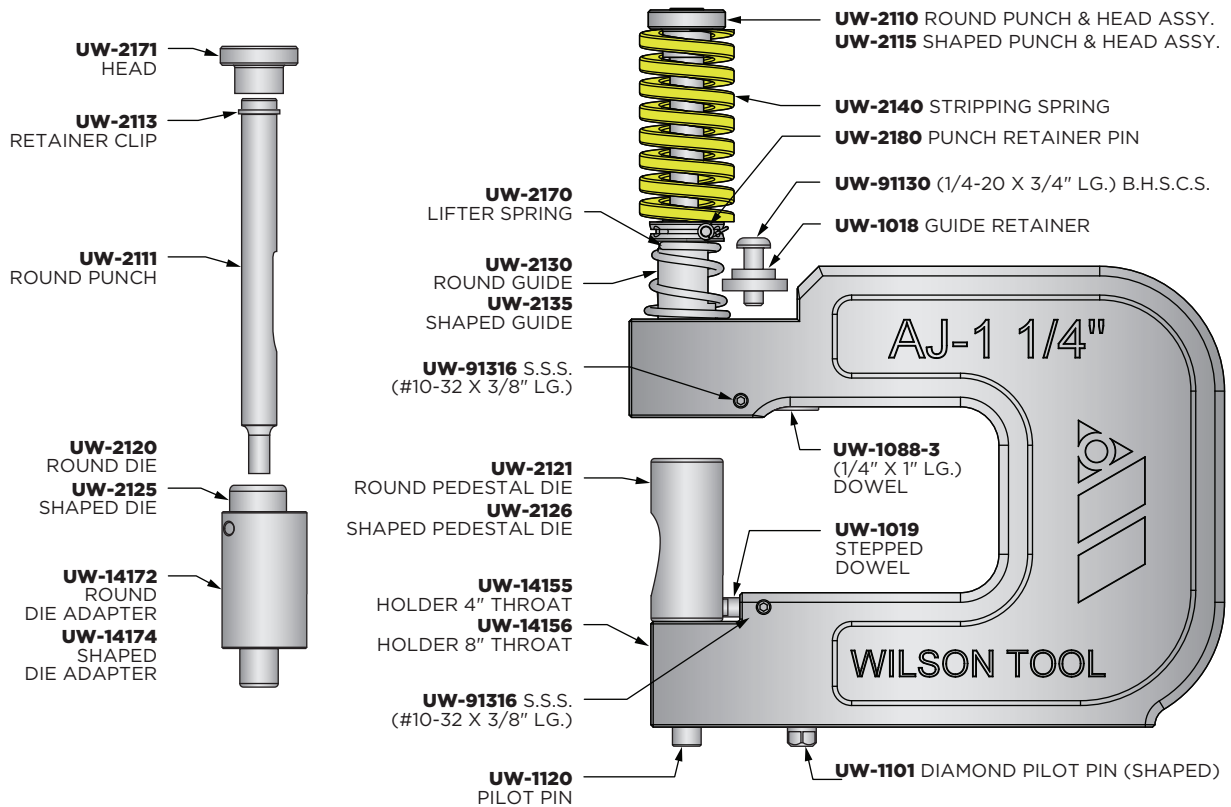

NOTE: All components are interchangeable with A units except the pedestal dies.

THROAT	ROUND UNITS		SHAPED UNITS	
	MODEL #	PART #	MODEL #	PART #
BASE UNITS LESS PUNCH, DIE & DIE ADAPTER				
4"	4A J-1/4P -LPD	UW-14100P-LPD	4SAJ-1/4P -LPD	UW-14105P-LPD
8"	8A J-1/4P -LPD	UW-14101P-LPD	8SAJ-1/4P -LPD	UW-14106P-LPD
BASE UNITS LESS PUNCH & DIE (includes die adapter)				
4"	4A J-1/4A -LPD	UW-14100A-LPD	4SAJ-1/4A -LPD	UW-14105A-LPD
8"	8A J-1/4A -LPD	UW-14101A-LPD	8SAJ-1/4A -LPD	UW-14106A-LPD

A-1 1/2"

WIDTH: 1-1/2" [38.0mm]

SPECIFICATIONS & OPERATING INSTRUCTIONS

MAX. MATERIAL THICKNESS	Mild Steel	1/4" [6.35mm]
	Stainless Steel	3/32" [2.38mm]
MAX. PUNCH DIAMETER / A DIM.	.6250" [15.87mm]	
MIN. PUNCH DIAMETER	.1250" [3.18mm]	

A SERIES TOOLING

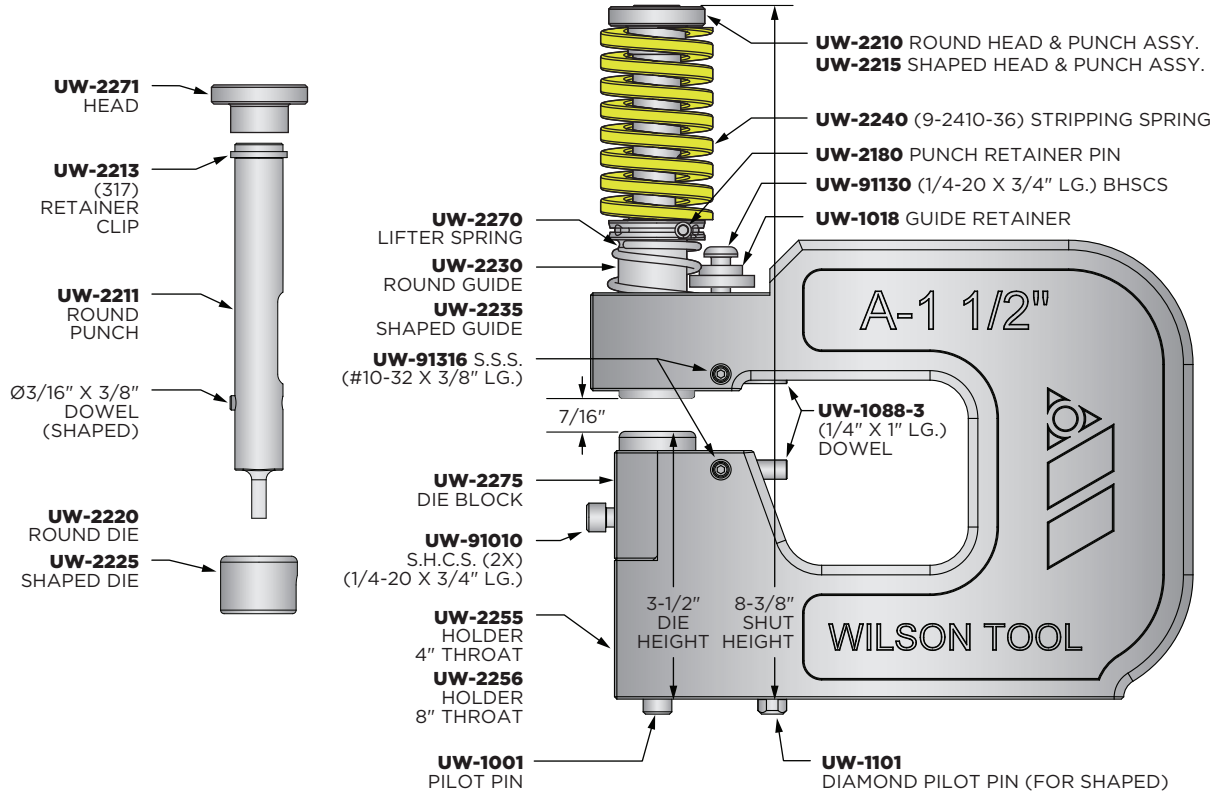

THROAT	ROUND UNITS		SHAPED UNITS	
	MODEL #	PART #	MODEL #	PART #
BASE UNITS LESS PUNCH & DIE (includes die adapter)				
4"	UW-4A-1½-LPD	UW-2203-LPD	UW-4SA-1½-LPD	UW-2205-LPD
8"	UW-8A-1½-LPD	UW-2200-LPD	UW-8SA-1½-LPD	UW-2206-LPD

AJ-1 1/2"

WIDTH: 1-1/2" [38.0mm]

SPECIFICATIONS & OPERATING INSTRUCTIONS

MAX. MATERIAL THICKNESS	Mild Steel	1/4" [6.4mm]
	Stainless Steel	1/8" [3.18mm]
MAX. PUNCH DIAMETER / A DIM.	.6250" [15.87mm]	
MIN. PUNCH DIAMETER	.1250" [3.18mm]	

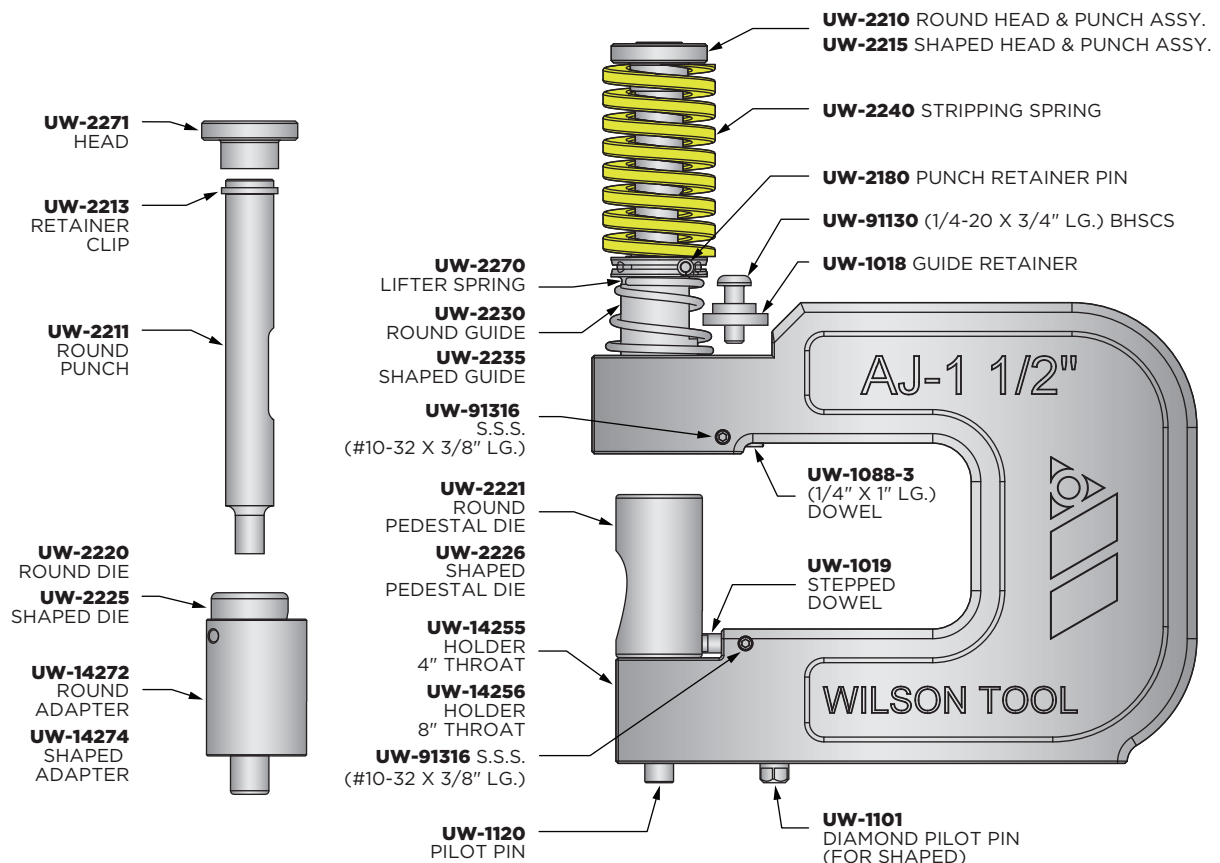

NOTE: All components are interchangeable with A units except the pedestal dies.

THROAT	ROUND UNITS		SHAPED UNITS	
	MODEL #	PART #	MODEL #	PART #
BASE UNITS LESS PUNCH, DIE & DIE ADAPTER				
4"	4AJ-1½P-LPD	UW-14200P-LPD	4SAJ-1½P-LPD	UW-14205P-LPD
8"	8AJ-1½P-LPD	UW-14201P-LPD	8SAJ-1½P-LPD	UW-14206P-LPD
BASE UNITS LESS PUNCH & DIE (includes die adapter)				
4"	4AJ-1½A-LPD	UW-14200A-LPD	4SAJ-1½A-LPD	UW-14205A-LPD
8"	8AJ-1½A-LPD	UW-14201A-LPD	8SAJ-1½A-LPD	UW-14206A-LPD

A-2"

WIDTH: 2" [50.8mm]

SPECIFICATIONS & OPERATING INSTRUCTIONS

MAX. MATERIAL THICKNESS	Mild Steel	1/4" [6.35mm]
	Stainless Steel	3/32" [2.38mm]
MAX. PUNCH DIAMETER / A DIM.	.8750" [22.22mm]	
MIN. PUNCH DIAMETER	.1875" [4.76mm]	

A SERIES TOOLING

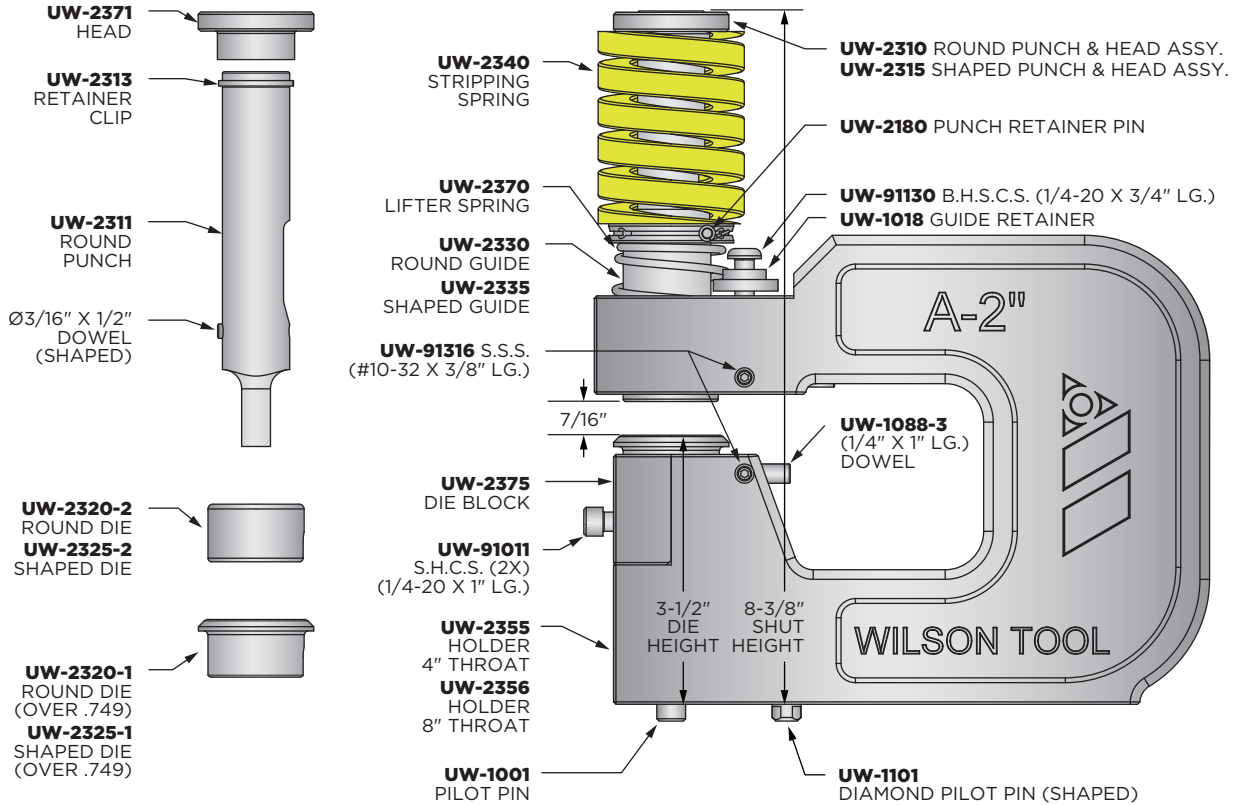

THROAT	ROUND UNITS		SHAPED UNITS	
	MODEL #	PART #	MODEL #	PART #
BASE UNITS LESS PUNCH & DIE				
4"	UW-4A-2-LPD	UW-2303-LPD	UW-4SA-2-LPD	UW-2305-LPD
8"	UW-8A-2-LPD	UW-2300-LPD	UW-8SA-2-LPD	UW-2306-LPD

AJ-2"

WIDTH: 2" [50.8mm]

SPECIFICATIONS & OPERATING INSTRUCTIONS

MAX. MATERIAL THICKNESS	Mild Steel	1/4" [6.4mm]
	Stainless Steel	1/8" [3.18mm]
MAX. PUNCH DIAMETER / A DIM.	.8750" [22.22mm]	
MIN. PUNCH DIAMETER	.1875" [4.76mm]	

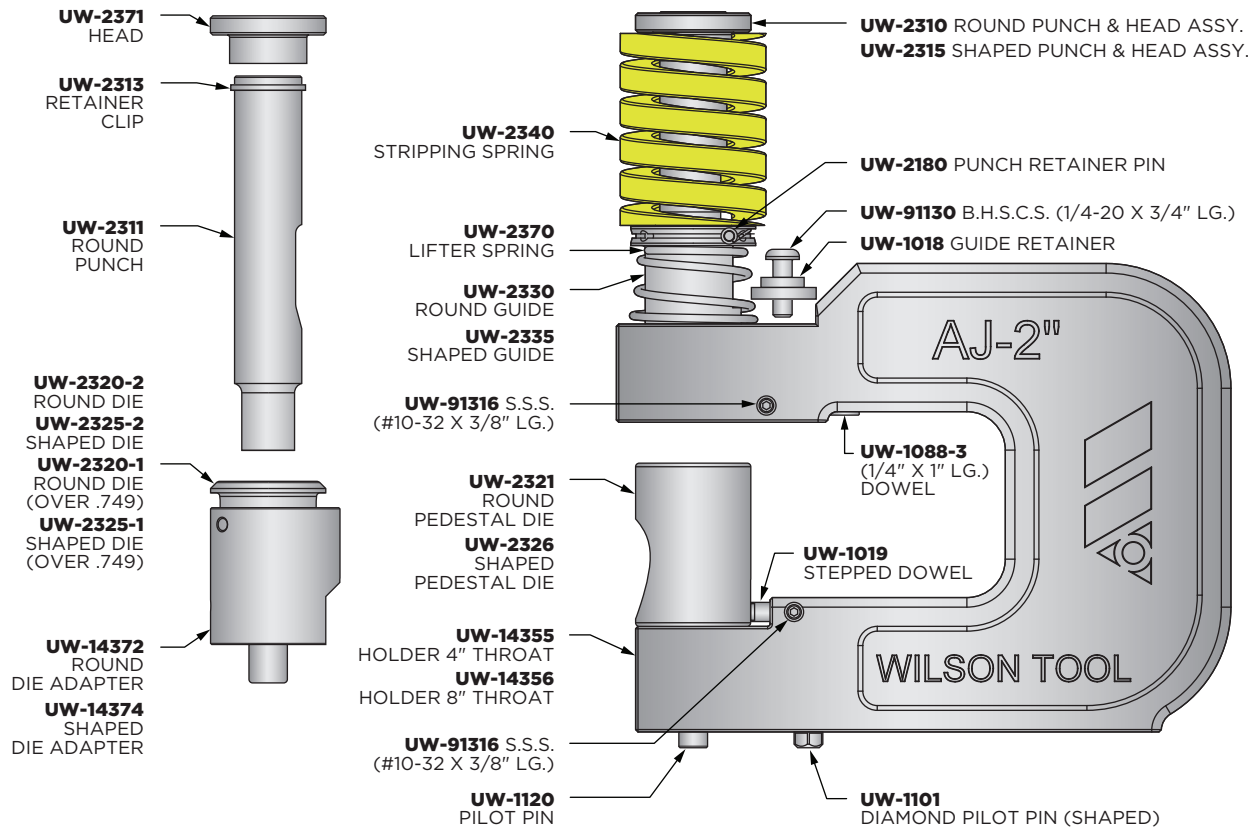

NOTE: All components are interchangeable with A units except the pedestal dies.

THROAT	ROUND UNITS		SHAPED UNITS	
	MODEL #	PART #	MODEL #	PART #
BASE UNITS LESS PUNCH, DIE & DIE ADAPTER				
4"	4AJ-2P-LPD	UW-14300P-LPD	4SAJ-2P-LPD	UW-14305P-LPD
8"	8AJ-2P-LPD	UW-14301P-LPD	8SAJ-2P-LPD	UW-14306P-LPD
BASE UNITS LESS PUNCH & DIE (includes die adapter)				
4"	4AJ-2A-LPD	UW-14300A-LPD	4SAJ-2A-LPD	UW-14305A-LPD
8"	8AJ-2A-LPD	UW-14301A-LPD	8SAJ-2A-LPD	UW-14306A-LPD

A SERIES TOOLING

A-2 1/2"

WIDTH: 2-1/2" [63.5mm]

SPECIFICATIONS & OPERATING INSTRUCTIONS

MAX. MATERIAL THICKNESS	Mild Steel	1/4" [6.35mm]
	Stainless Steel	3/32" [2.4mm]
MAX. PUNCH DIAMETER / A DIM.	1.50" [38.10mm]	
MIN. PUNCH DIAMETER	.281" [7.14mm]	

A SERIES TOOLING

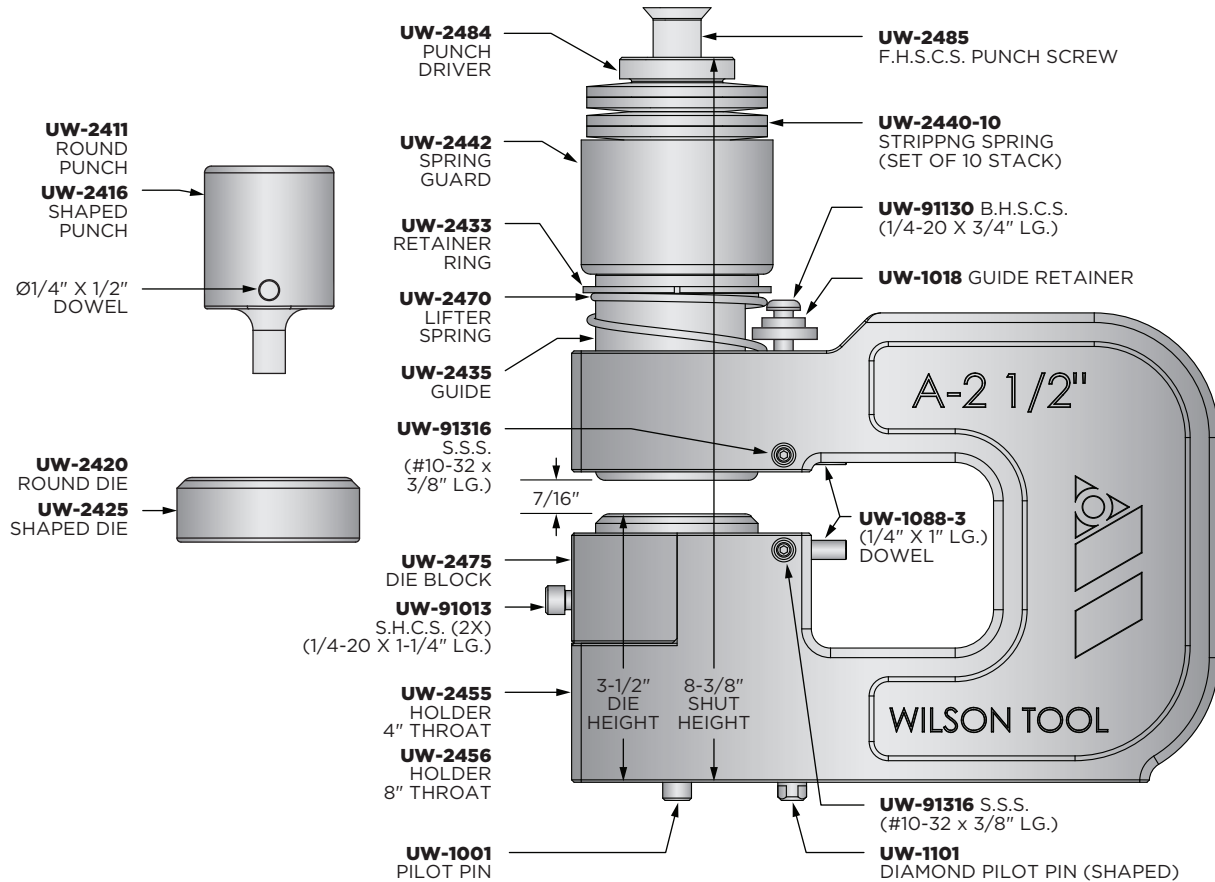

THROAT	ROUND UNITS		SHAPED UNITS	
	MODEL #	PART #	MODEL #	PART #
BASE UNITS LESS PUNCH & DIE (includes die adapter)				
4"	UW-4A-2½-LPD	UW-2400-LPD	UW-4SA-2½-LPD	UW-2405-LPD
8"	UW-8A-2½-LPD	UW-2401-LPD	UW-8SA-2½-LPD	UW-2406-LPD

AJ-2 1/2"

WIDTH: 2-1/2" [63.5mm]

SPECIFICATIONS & OPERATING INSTRUCTIONS

MAX. MATERIAL THICKNESS	Mild Steel	1/4" [6.4mm]
	Stainless Steel	1/8" [3.18mm]
MAX. PUNCH DIAMETER / A DIM.	1.25" [31.75mm]	
MIN. PUNCH DIAMETER	.281" [7.14mm]	

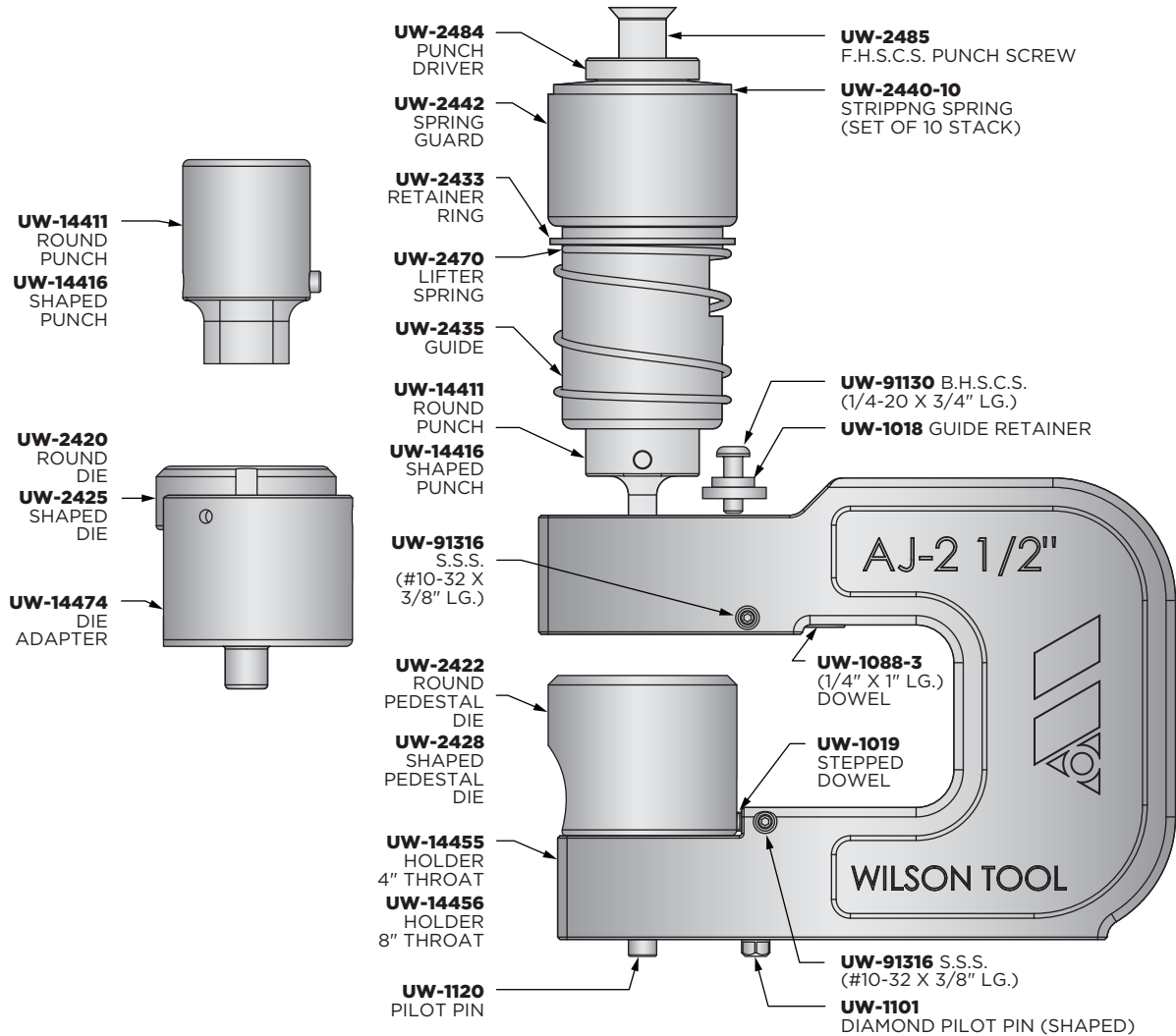

NOTE: All components are interchangeable with A units except the pedestal dies.

THROAT	ROUND UNITS		SHAPED UNITS	
	MODEL #	PART #	MODEL #	PART #
BASE UNITS LESS PUNCH, DIE & DIE ADAPTER				
4"	4AJ-2½P-LPD	UW-14400P-LPD	4SAJ-2½P-LPD	UW-14405P-LPD
8"	8AJ-2½P-LPD	UW-14401P-LPD	8SAJ-2½P-LPD	UW-14406P-LPD
BASE UNITS LESS PUNCH & DIE (includes die adapter)				
4"	4AJ-2½A-LPD	UW-14400A-LPD	4SAJ-2½A-LPD	UW-14405A-LPD
8"	8AJ-2½A-LPD	UW-14401A-LPD	8SAJ-2½A-LPD	UW-14406A-LPD

A SERIES TOOLING

FCU-1 1/4"

WIDTH: 1-1/4" [31.8mm]

SPECIFICATIONS & OPERATING INSTRUCTIONS

MAX. MATERIAL THICKNESS	Mild Steel	1/8" [3.18mm]
	Stainless Steel	1/16" [1.59mm]
MAX. PUNCH DIAMETER / A DIM.	.437" [11.10mm]	
MIN. PUNCH DIAMETER	.0937" [2.38mm]	

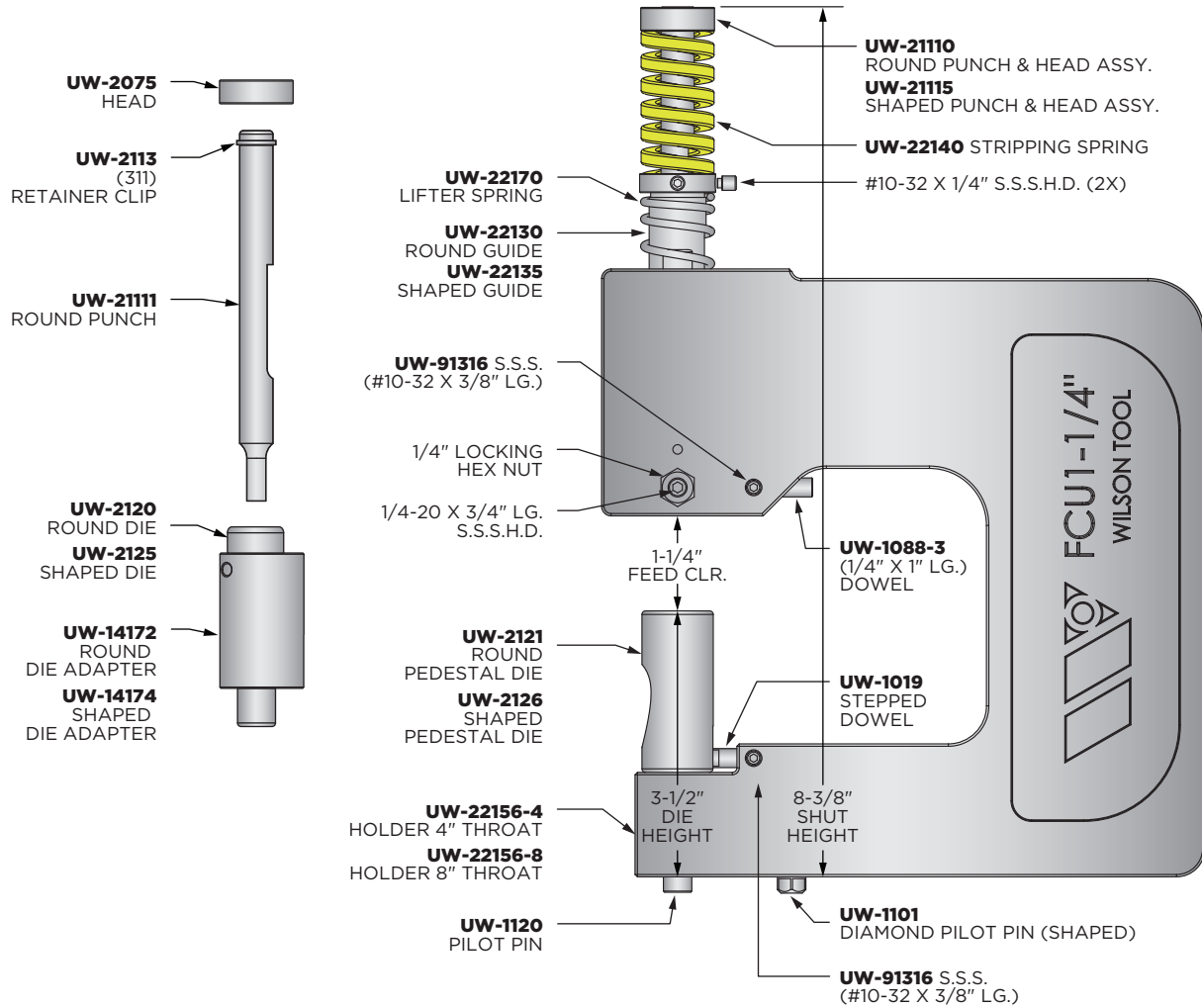

THROAT	ROUND UNITS		SHAPED UNITS	
	MODEL #	PART #	MODEL #	PART #
STANDARD UNITS COMPLETE WITH PUNCH, DIE & DIE ADAPTER				
4"	4FCU-1 1/4 A	UW-22101-4A-LPD	4SFCU-1 1/4 A	UW-22106-4A-LPD
8"	8FCU-1 1/4 A	UW-22101-8A-LPD	8SFCU-1 1/4 A	UW-22106-8A-LPD
OPTIONAL UNITS COMPLETE WITH PUNCH & PEDESTAL DIE				
4"	4FCU-1 1/4 P	UW-22101-4P-LPD	4SFCU-1 1/4 P	UW-22106-4P-LPD
8"	8FCU-1 1/4 P	UW-22101-8P-LPD	8SFCU-1 1/4 P	UW-22106-8P-LPD

FCU-1½"

WIDTH: 1-1/2" [38.0mm]

SPECIFICATIONS & OPERATING INSTRUCTIONS

MAX. MATERIAL THICKNESS	Mild Steel	1/8" [3.18mm]
	Stainless Steel	1/16" [1.59mm]
MAX. PUNCH DIAMETER / A DIM.	.625" [15.88mm]	
MIN. PUNCH DIAMETER	.0937" [2.38mm]	

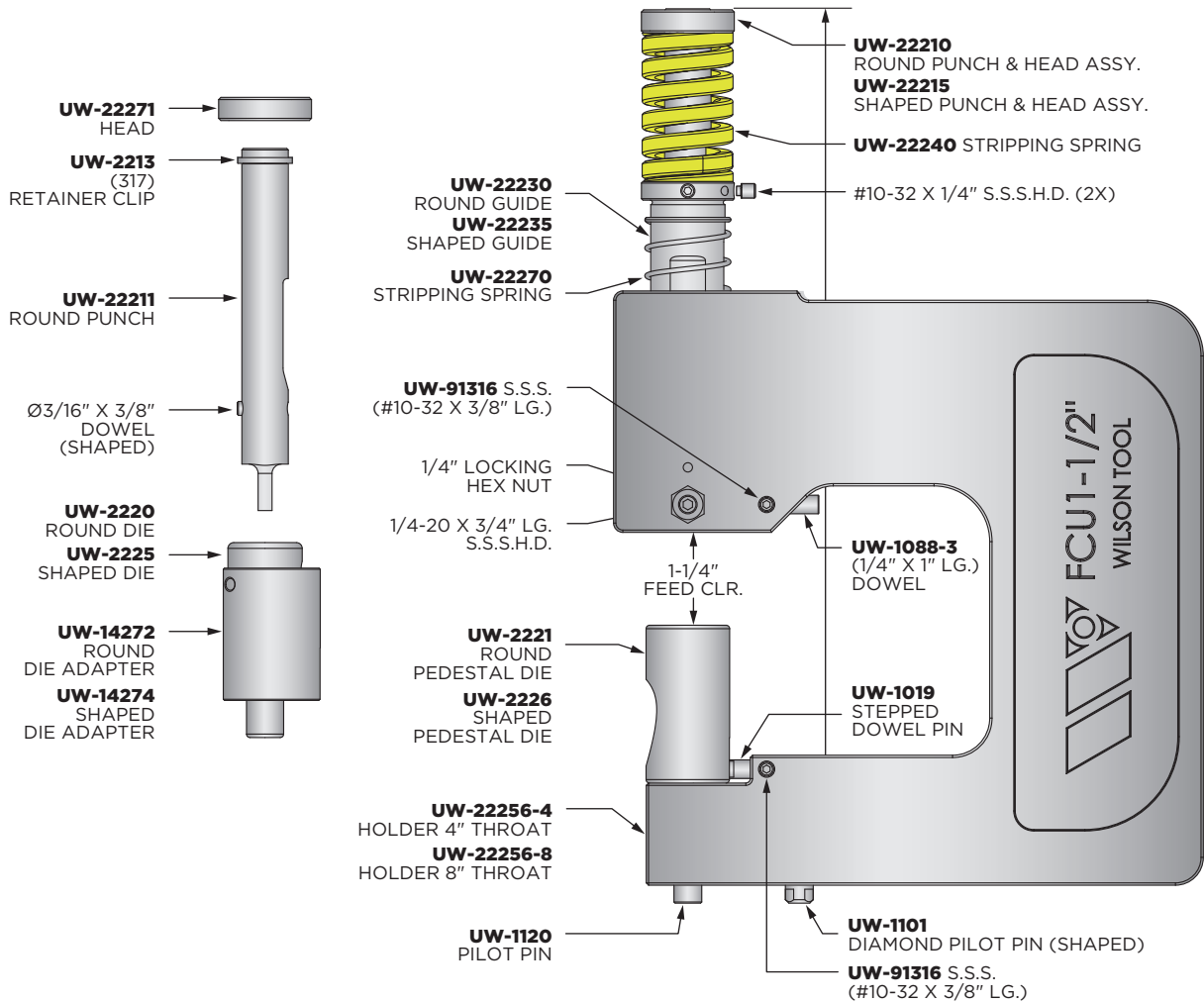

THROAT	ROUND UNITS		SHAPED UNITS	
	MODEL #	PART #	MODEL #	PART #
STANDARD UNITS COMPLETE WITH PUNCH, DIE & DIE ADAPTER				
4"	4FCU-1½A	UW-22201-4A-LPD	4SFCU-1½A	UW-22206-4A-LPD
8"	8FCU-1½A	UW-22201-8A-LPD	8SFCU-1½A	UW-22206-8A-LPD
OPTIONAL UNITS COMPLETE WITH PUNCH & PEDESTAL DIE				
4"	4FCU-1½P	UW-22201-4P-LPD	4SFCU-1½P	UW-22206-4P-LPD
8"	8FCU-1½P	UW-22201-8P-LPD	8SFCU-1½P	UW-22206-8P-LPD

F SERIES TOOLING

A-3 1/2"

WIDTH: 3-1/2" [88.9mm]

SPECIFICATIONS & OPERATING INSTRUCTIONS

MAX. MATERIAL THICKNESS	Mild Steel	1/4" [6.4mm]
	Stainless Steel	3/32" [2.4mm]
MAX. PUNCH DIAMETER / A DIM.	2.0" [50.80mm]	
MIN. PUNCH DIAMETER	.5" [12.70mm]	

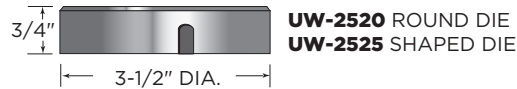
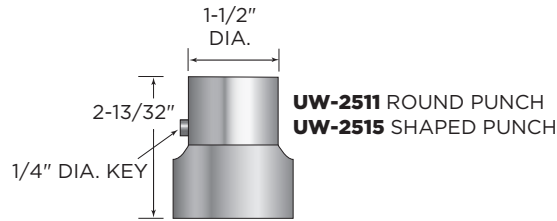

A-5 1/2"

WIDTH: 5-1/2" [139.7mm]

SPECIFICATIONS & OPERATING INSTRUCTIONS

MAX. MATERIAL THICKNESS	Mild Steel	1/4" [6.4mm]
	Stainless Steel	3/32" [2.4mm]
MAX. PUNCH DIAMETER / A DIM.	3.0" [76.20mm]	
MIN. PUNCH DIAMETER	1.0" [15.40mm]	

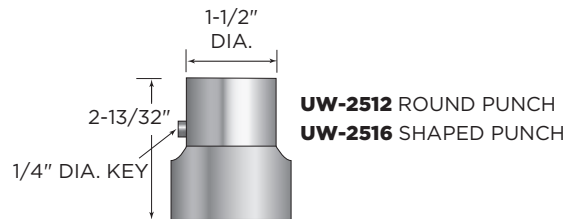

BX-3/4"

WIDTH: 3/4" [19mm]

SPECIFICATIONS & OPERATING INSTRUCTIONS

MAX. MATERIAL THICKNESS	Mild Steel	10 GA. .134" [3.4mm]
	Stainless Steel	1/16" [1.6mm]
MAX. PUNCH DIAMETER / A DIM.	.3125" [7.93mm]	
MIN. PUNCH DIAMETER	.0937" [2.38mm]	

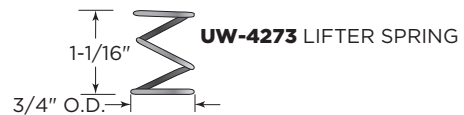
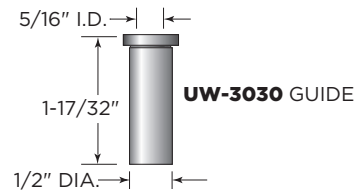
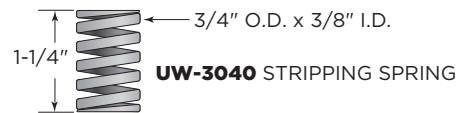
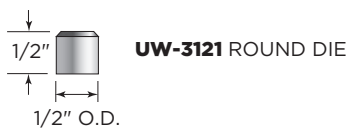
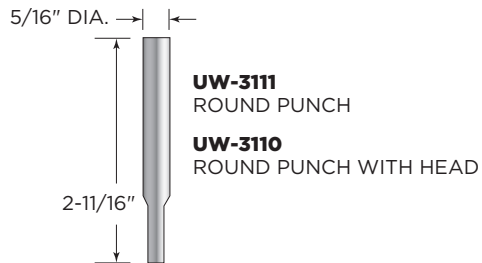

B-1"

WIDTH: 1" [25.4mm]

SPECIFICATIONS & OPERATING INSTRUCTIONS

MAX. MATERIAL THICKNESS	Mild Steel	10 GA. .134" [3.4mm]
	Stainless Steel	1/16" [1.6mm]
MAX. PUNCH DIAMETER / A DIM.	.3750" [9.52mm]	
MIN. PUNCH DIAMETER	.0937" [2.38mm]	

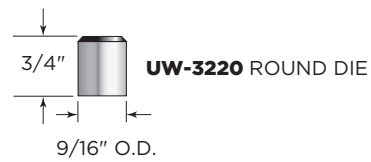
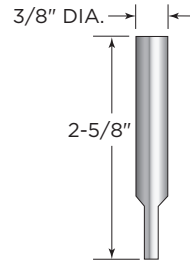

B SERIES TOOLING

B-1 1/4"

WIDTH: 1-1/4" [31.8mm]

SPECIFICATIONS & OPERATING INSTRUCTIONS

MAX. MATERIAL THICKNESS	Mild Steel	10 GA. .134" [3.4mm]
	Stainless Steel	1/16" [1.6mm]
MAX. PUNCH DIAMETER / A DIM.	.3750" [9.52mm]	
MIN. PUNCH DIAMETER	.0937" [2.38mm]	

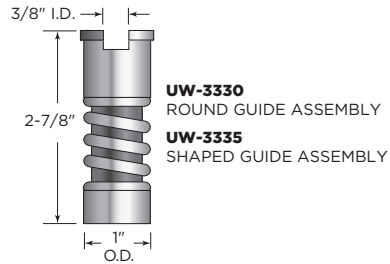
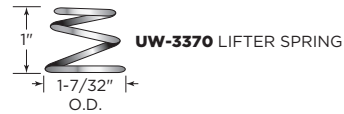
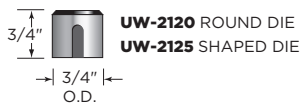
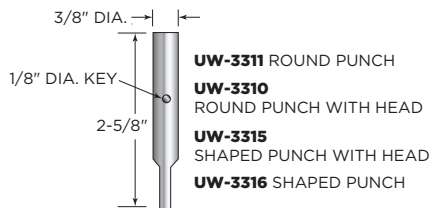

B-1³/₄"

WIDTH: 1-3/4" [44.5mm]

SPECIFICATIONS & OPERATING INSTRUCTIONS		
MAX. MATERIAL THICKNESS	Mild Steel	10 GA. .134" [3.4mm]
	Stainless Steel	1/16" [1.6mm]
MAX. PUNCH DIAMETER / A DIM.		.5000" [12.70mm]
MIN. PUNCH DIAMETER		.1250" [3.18mm]

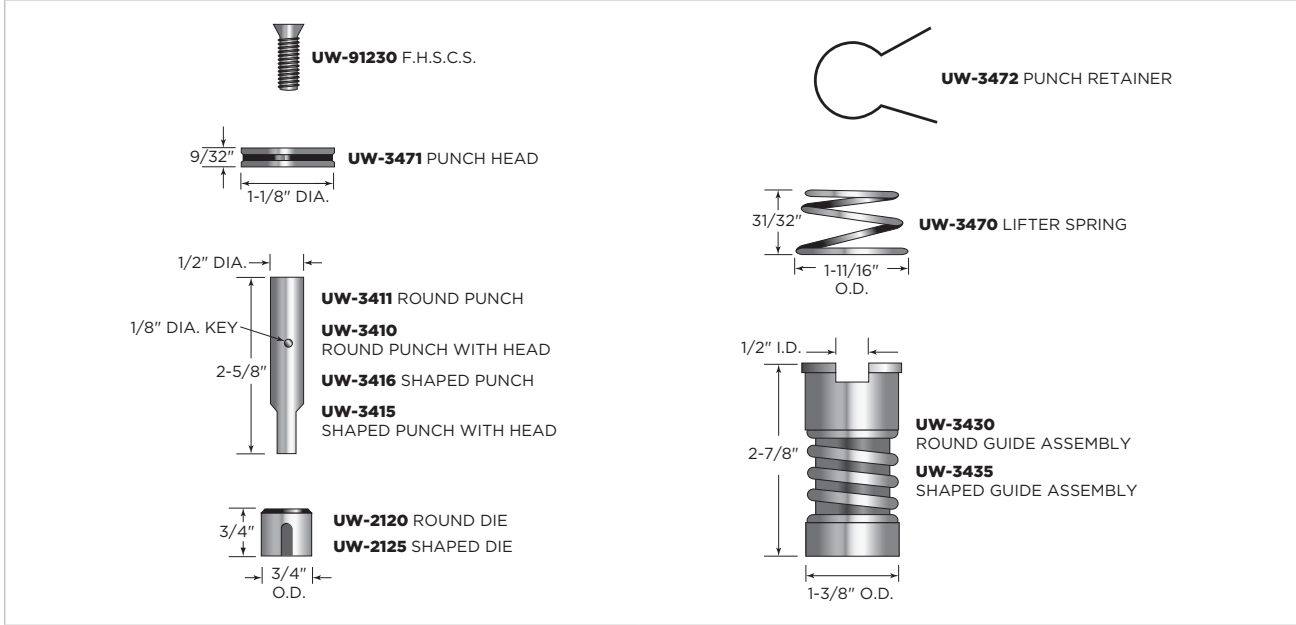

UW-91230 F.H.S.C.S.

UW-3471 PUNCH HEAD
9/32" height, 1-1/8" DIA.

UW-3411 ROUND PUNCH
1/2" DIA.

UW-3410 ROUND PUNCH WITH HEAD
1/8" DIA. KEY

UW-3416 SHAPED PUNCH
2-5/8" length

UW-3415 SHAPED PUNCH WITH HEAD
2-5/8" length

UW-2120 ROUND DIE
3/4" height

UW-2125 SHAPED DIE
3/4" height, 3/4" O.D.

UW-3472 PUNCH RETAINER

UW-3470 LIFTER SPRING
31/32" height, 1-11/16" O.D.

UW-3430 ROUND GUIDE ASSEMBLY
1/2" I.D., 2-7/8" height, 1-3/8" O.D.

UW-3435 SHAPED GUIDE ASSEMBLY
1/2" I.D., 2-7/8" height, 1-3/8" O.D.

BX-2¹/₄"

WIDTH: 2-1/4" [19mm]

SPECIFICATIONS & OPERATING INSTRUCTIONS		
MAX. MATERIAL THICKNESS	Mild Steel	10 GA. .134" [3.4mm]
	Stainless Steel	1/16" [1.6mm]
MAX. PUNCH DIAMETER / A DIM.		1.0" [25.40mm]
MIN. PUNCH DIAMETER		.250" [6.25mm]

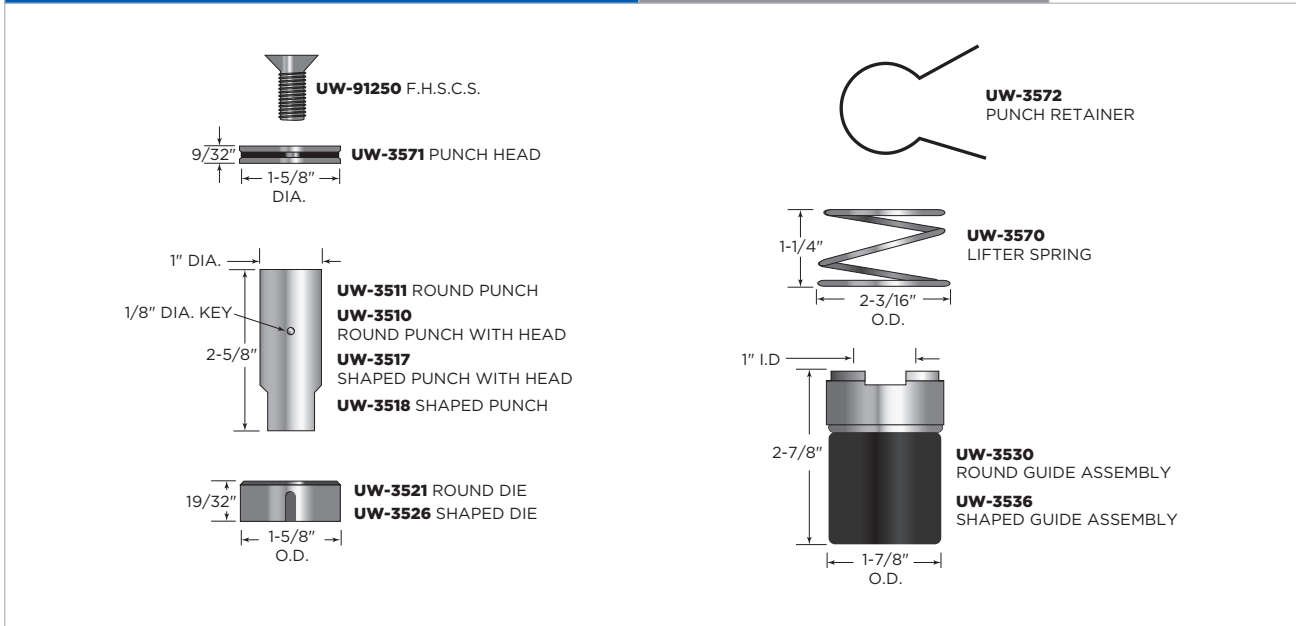

UW-91250 F.H.S.C.S.

UW-3571 PUNCH HEAD
9/32" height, 1-5/8" DIA.

UW-3511 ROUND PUNCH
1" DIA.

UW-3510 ROUND PUNCH WITH HEAD
1/8" DIA. KEY

UW-3517 SHAPED PUNCH WITH HEAD
2-5/8" length

UW-3518 SHAPED PUNCH
2-5/8" length

UW-3521 ROUND DIE
19/32" height

UW-3526 SHAPED DIE
19/32" height, 1-5/8" O.D.

UW-3572 PUNCH RETAINER

UW-3570 LIFTER SPRING
1-1/4" height, 2-3/16" O.D.

UW-3530 ROUND GUIDE ASSEMBLY
1" I.D., 2-7/8" height, 1-7/8" O.D.

UW-3536 SHAPED GUIDE ASSEMBLY
1" I.D., 2-7/8" height, 1-7/8" O.D.

B SERIES TOOLING

B-3"

WIDTH: 3" [76.2mm]

SPECIFICATIONS & OPERATING INSTRUCTIONS

MAX. MATERIAL THICKNESS	Mild Steel	10 GA. .134" [3.4mm]
	Stainless Steel	1/16" [1.6mm]
MAX. PUNCH DIAMETER / A DIM.	2.0" [50.80mm]	
MIN. PUNCH DIAMETER	.5000" [12.7mm]	

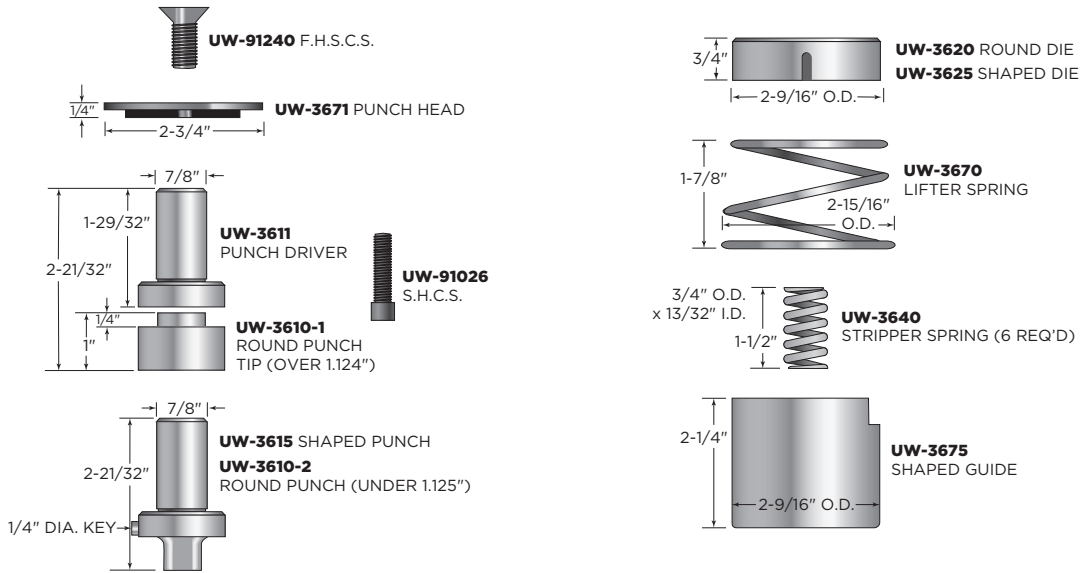

B-5"

WIDTH: 5" [127mm]

SPECIFICATIONS & OPERATING INSTRUCTIONS

MAX. MATERIAL THICKNESS	Mild Steel	10 GA. .134" [3.4mm]
	Stainless Steel	1/16" [1.6mm]
MAX. PUNCH DIAMETER / A DIM.	3.5" [88.90mm]	
MIN. PUNCH DIAMETER	1.0" [25.40mm]	

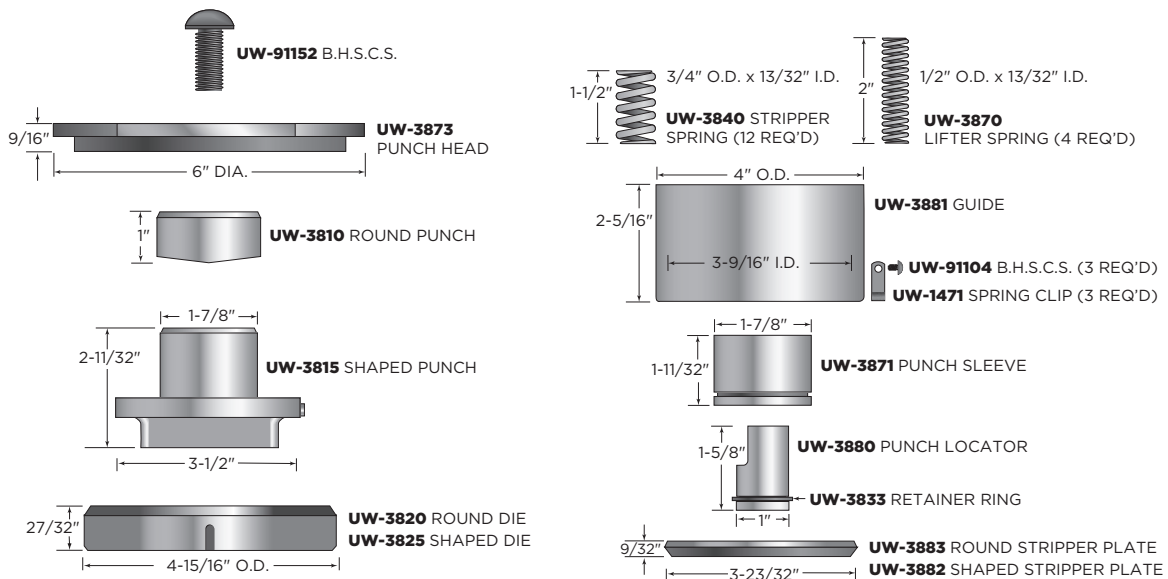

G-3/4"

WIDTH: 3/4" [19mm]

SPECIFICATIONS & OPERATING INSTRUCTIONS

MAX. MATERIAL THICKNESS	Mild Steel	3/16" [4.8mm]
	Stainless Steel	.062" [1.57mm]
MAX. PUNCH DIAMETER / A DIM.		.3125" [7.93mm]
MIN. PUNCH DIAMETER		.0937" [2.38mm]

TRIPLE SPRING COMPONENTS

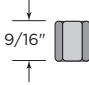

UW-4219 HEAD NUT

9/16"



UW-4239 LOCK NUT

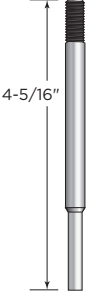

UW-4217 PUNCH
UW-4218 PUNCH COMPLETE

4-5/16"

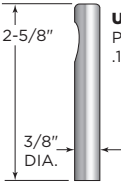

UW-4221 PEDESTAL DIE
.174" MAX. DIA.

2-5/8"
3/8" DIA.

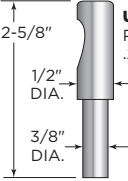

UW-4222 PEDESTAL DIE
.268" MAX. DIA.

2-5/8"
1/2" DIA.
3/8" DIA.

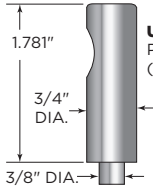

UW-4226 PEDESTAL DIE
(.330" MAX. DIA.)

1.781"
3/4" DIA.
3/8" DIA.

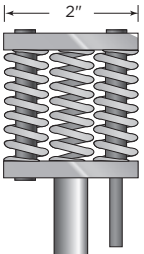

UW-4413 TRIPLE SPRING STRIPPING GUIDE ASSEMBLY
(SPECIFY PUNCH SIZE WHEN ORDERING)

2"



UW-4243 RETAINER RING

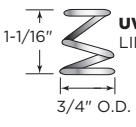

UW-4273 LIFTER SPRING

1-1/16"
3/4" O.D.

G-3/4"

WIDTH: 3/4" [19mm]

SPECIFICATIONS & OPERATING INSTRUCTIONS

MAX. MATERIAL THICKNESS	Mild Steel	.104" [2.64mm]
	Stainless Steel	.031" [0.787mm]
MAX. PUNCH DIAMETER / A DIM.		.250" [6.35mm]
MIN. PUNCH DIAMETER		.0937" [2.38mm]

SINGLE SPRING COMPONENTS

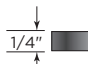

UW-4279 PUNCH HEAD

1/4"



UW-4216 PUNCH BODY
UW-4215 PUNCH WITH HEAD

3-1/8" NEW LENGTH
3" THROW AWAY LENGTH

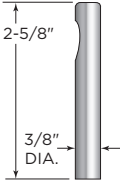

UW-4221 PEDESTAL DIE
.174" MAX. DIA.

2-5/8"
3/8" DIA.

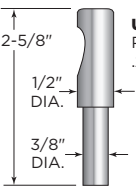

UW-4222 PEDESTAL DIE
.268" MAX. DIA.

2-5/8"
1/2" DIA.
3/8" DIA.

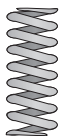

UW-4440 STRIPPING SPRING



UW-4431 GUIDE
(SPECIFY PUNCH DIA. WHEN ORDERING)

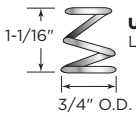

UW-4273 LIFTER SPRING

1-1/16"
3/4" O.D.

IRONWORKER TOOLING

Ironworker punches and dies are available for most of today's Ironworker machines requiring the cutting, punching and notching of heavier gauge materials. If we do not carry standard products for your specific machine, we will gladly manufacture any custom tooling you may need.

Scan QR Code to View the Ironworker Tooling Catalog

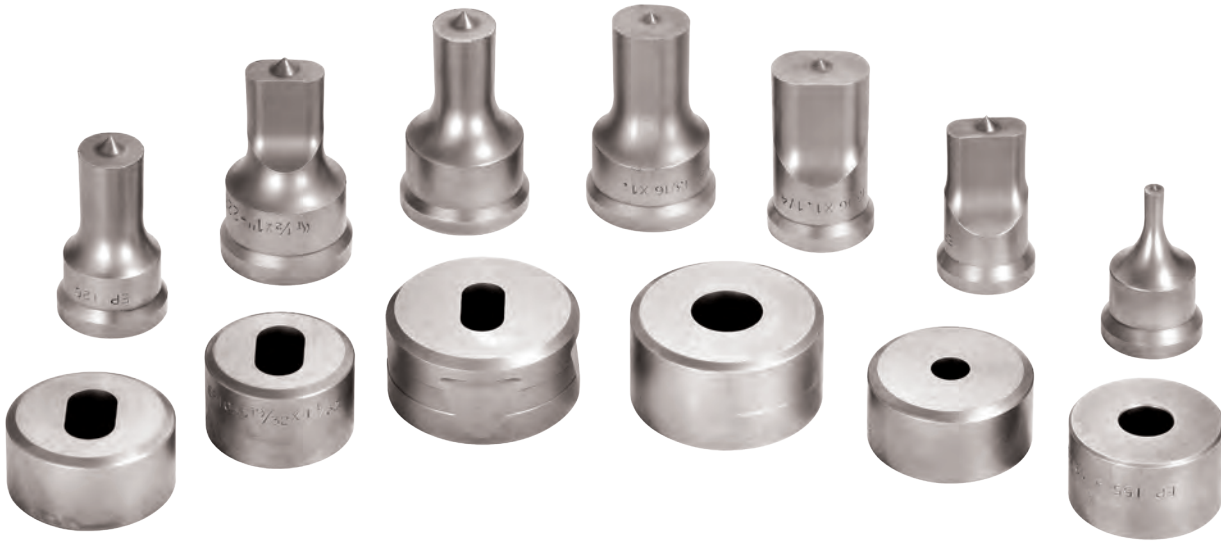

IRONWORKER TOOLING

Ironworker Tooling from Wilson Tool International includes:

- Stock and Non-Stock Dies and Punches
- Bateman™ / Lehman™
- Buffalo™ Punches and Dies
- Edwards™ Tooling
- Geka™ Punches
- Hougen™ / Ogura™
- Kingsland™
- Mubea™
- Nitto Kohki™
- Peddinghaus™
- Piranha™
- Scothmann™ / Uni-Hydro™
- Taper Shank Punches



All trademarks are the property of their respective owners.

WHITNEY-STYLE TOOLING

Our extensive collection of 28xx, 36tc, and single station tooling offers a comprehensive solution for your fabrication needs, from basic shapes to complex designs. These versatile punch and dies can handle a wide range of applications, ensuring precise and efficient production.



WHITNEY-STYLE TOOLING

Whitney-Style Tooling from Wilson Tool International includes:

- 28XX Tooling — W6300 Series
- 28XX Tooling — W6100 Series
- Portable — W700 Series
- Bench Press — W91 Series
- 36TC Tooling
- Punch Press
Tooling Accessories
- Kick Press Tooling

Scan QR Code
to View the
Whitney-Style
Tooling Catalog



THE DIVISIONS OF WILSON TOOL INTERNATIONAL

BENDING

Wilson Tool's Bending division delivers the most complete line of tooling and clamping solutions available anywhere.

Whether you use American, European, WT, Bystronic or LVD-style precision or conventional tooling, Wilson Tool has a solution for you. Our clamping options cover these styles as well. With hydraulic push button, quick release mechanical or standard manual clamps, we have a clamping solution for any style of machine or budget. And our custom tooling manufacturing capabilities are the envy of the industry with innovative solutions for complex bending challenges. With manufacturing facilities located in the USA and Canada, our delivery times to North American fabricators are the fastest in the industry.



STAMPING



Wilson Tool's Stamping division, Impax Tooling Solutions®, offers high quality punch and die components, accessories and retainers for the stamping industry.

Innovative products such as our HP Accu-Lock® Retainer Inserts and extensive coating options, combined with our world-class customer service, have enabled us to quickly grow into a world-class provider. With a direct sales force throughout North America, we deliver products straight from the factory to you, enabling the fastest deliveries in the industry. Our custom tooling expertise is second to none with many customers coming to us for their most difficult stamping challenges.

PUNCHING

Wilson Tool's Punching division continues to drive the industry with new levels of quality, delivery, service and innovation.

From the early days of Series 80 to the Wilson Wheel® Family to EXP® technology, our punching division has been the industry-leading innovation driver.

Combined with the most experienced customer support professionals in the industry, Wilson Tool continues to raise the bar. Thick turret, TRUMPF-style, Salvagnini-style, or any other style of punch press you may be using, Wilson Tool offers the most complete line of tooling solutions available today.



TRUMPF is a trademark of TRUMPF GmbH + Co. KG.

ACCESSORIES



Whether you need storage systems, grinders, urethane rolls, hand tools or related supplies, we offer a wide range of solutions to help you be more productive, organized and efficient.



CUSTOM UNITS

Custom units are available to provide solutions for your punching and notching needs. Whether it's flat material or extruded material, we have the answers!

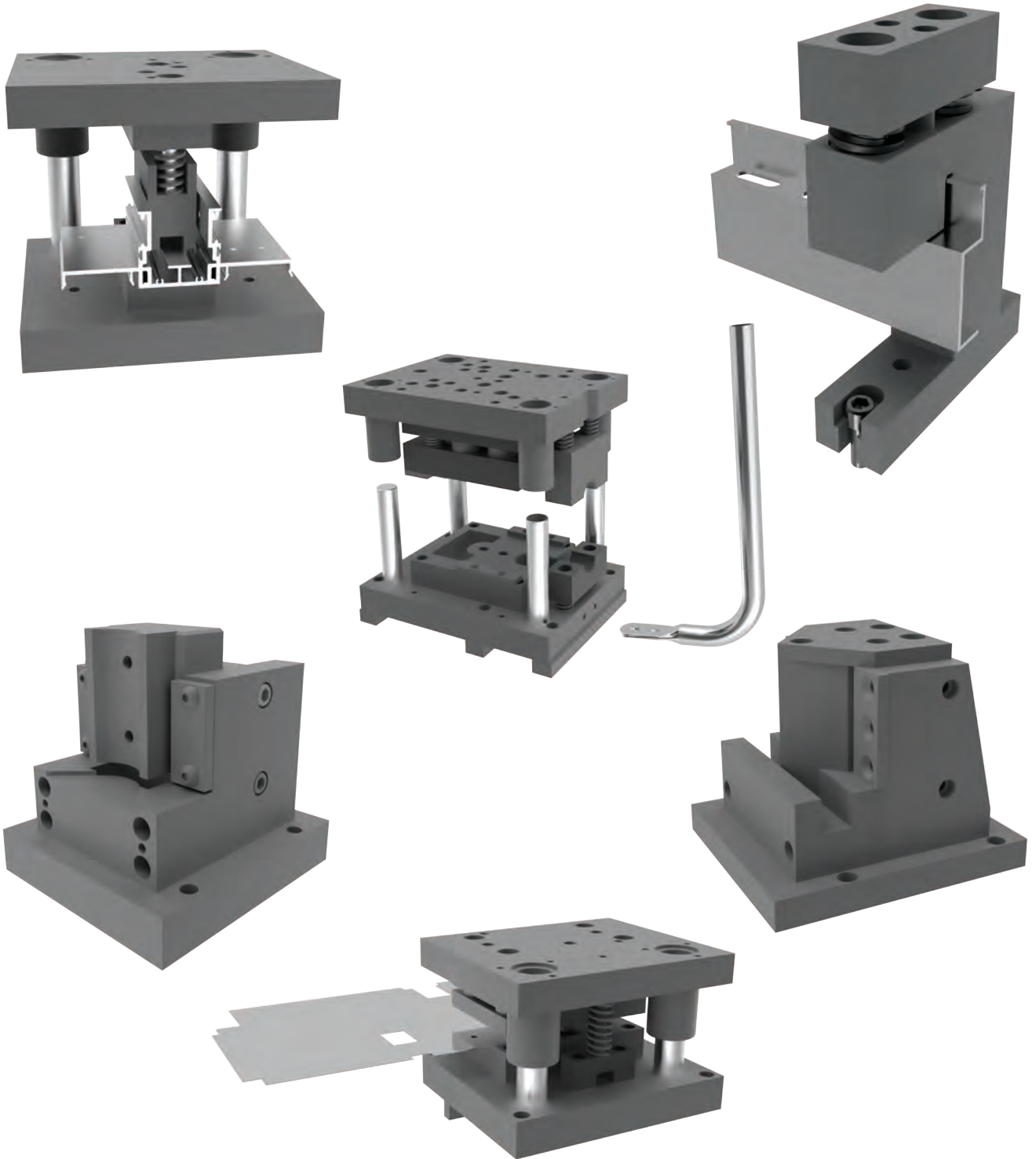

CUSTOM UNITS

WILSON TOOL INTERNATIONAL CANADA OFFICES

4-5590 Finch Avenue E, Toronto, ON M1B 1T1

800.268.5573 | punching@wilsontoolcanada.com

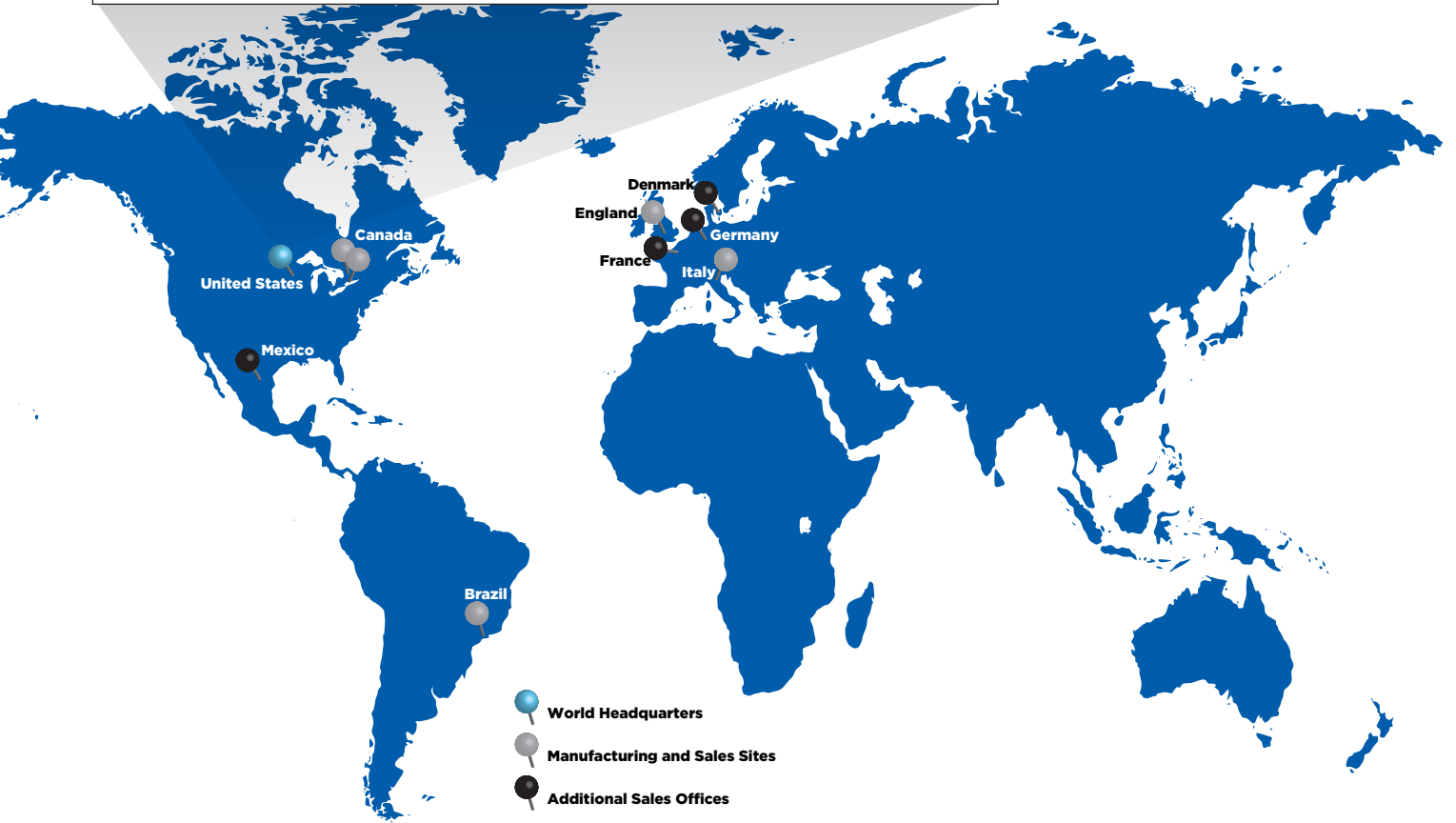

GUARANTEED TO OUTPERFORM

With Wilson Tool International, you're not just receiving tools — you're gaining a partner dedicated to your productivity, and products backed with a guarantee to outperform your current tooling.



E609C (3.2026)